

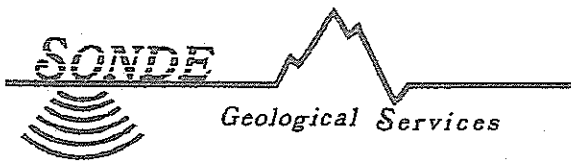

PIONEER FIRE PROTECTION DISTRICT
FIRE • RESCUE • EMS

P.O. Box 128
7061 Mt. Aukum Road
Somerset, California 95684
Phone (530) 620-4444 • Fax (530) 620-4317
www.pioneerfire.org

Pioneer Fire Protection District accepting Bids for Septic System Repair
Location 7061 Mt Aukum Rd, Somerset CA 95684
Deliver Bids to admin@pioneerfire.org
Bid Opening date 4/29/2022 5pm
Bid Closing Date 5/13/2022 5pm



3369 Kimberly Road
Cameron Park, CA 95682
(530) 677-3055

Professional Geologist #4717

PERCOLATION TEST REPORT

Date: March 30, 2022

Owner/Builder & Address:

APN: 046-520-041

Pioneer Fire Protection district
c/o Josh Schwitalla
P.O. Box 128
Somerset, CA 95684

Day Phone: (916) 600-3014

Water Source: Well

Purpose of Test: Repair for 3-Bedroom House

Directions to Property: 7061 Mt Aukum Road

Date of Test: 12/19/1984 – Petite & Brewster

Weather at time of Test: Unknown

Soil Profile: 0-10' Brown sandy soil grading to very weathered granitic rock below 5 feet

TEST DATA

Hole Number: 1 2 3 4

Depth of Test Holes (inches): On File

Stabilized Perc. Rate (min/inch): On file

Number of Holes: 4

Average Percolation Rate: 8.4 minutes per inch

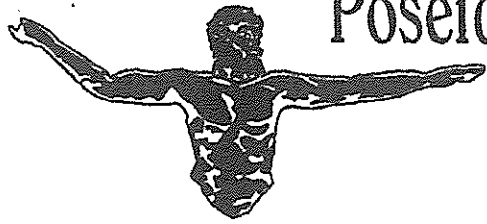

Poseidon Consulting Services

"CONSORTS OF THE EARTH"

177313

well
production

2600 Consolation Court
Shingle Springs, CA 95682
(530) 676-4983

REPORT OF PERCOLATION TEST

Pioneer Fire Department
111 Mt. Aukum Road

APN 046-520-41

TEST DATE 12-19-84* WEATHER CLEAR

NUMBER OF HOLES TESTED 4

Test Holes shown on Location Map

Test Hole Depth (ft.) Stabilized Percolation Rate

Note: original percolation test done by Petite & Brewster December 19, 1984
Copy attached to this design

Average Percolation Rate 8.400 Minutes per Inch

SEPTIC SYSTEM DESIGN BY: GEORGE A. WHEELDON, R.G.

9001

SEPTIC DESIGN

<u>3</u> Bedroom House =	<u>1,650</u>	Gal/Day
Average Percolation Rate =	<u>8.4</u>	Min/inch
Allowable Application Rate =	<u>1.725</u>	Gal/Sq ft/Day
Required Surface Area =	<u>377</u>	Square feet
Depth of System (D) =	<u>5</u>	Feet
Width of System (W) =	<u>1.5</u>	Feet
Length of System (L) =	<u>55</u>	Feet (Sq Ft = 2(L + W)(D - 1.5))

Leach Field Trench & Lateral Details

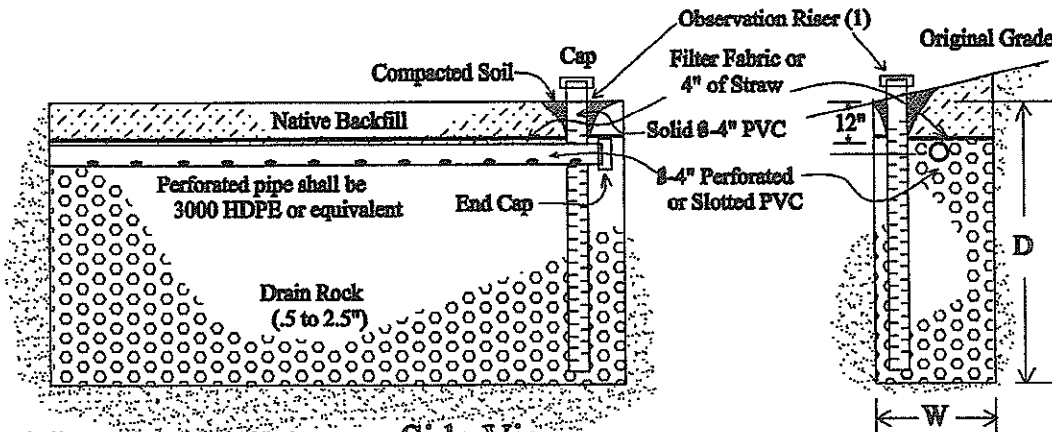

(1) Riser shall extend a min of 12" above surface or be encased in a properly constructed christy box. Riser to be located at the end of all lines.

Trench Design

Other Design Considerations

- 1) All tight lines shall be schedule 40 PVC, ABS or SDR 35.
- 2) Lines must be constructed level or with a maximum of 3 inch fall in 100 feet
- 3) An Effluent filter required on tank outlet.
- 4) Septic tank lids (manholes) shall be brought to grade, with water tight gaskets

SONDE GEOLOGICAL SERVICES

3369 Kimberly Road
CAMERON PARK, CA 95682
(530) 677-3055

JOB PIONEER FIRE PROTECTION
SHEET NO. PLOT PLAN APN 046-526-041 OF _____
CALCULATED BY CLH DATE 3/30/21
CHECKED BY _____ DATE _____
SCALE 1" = 40'

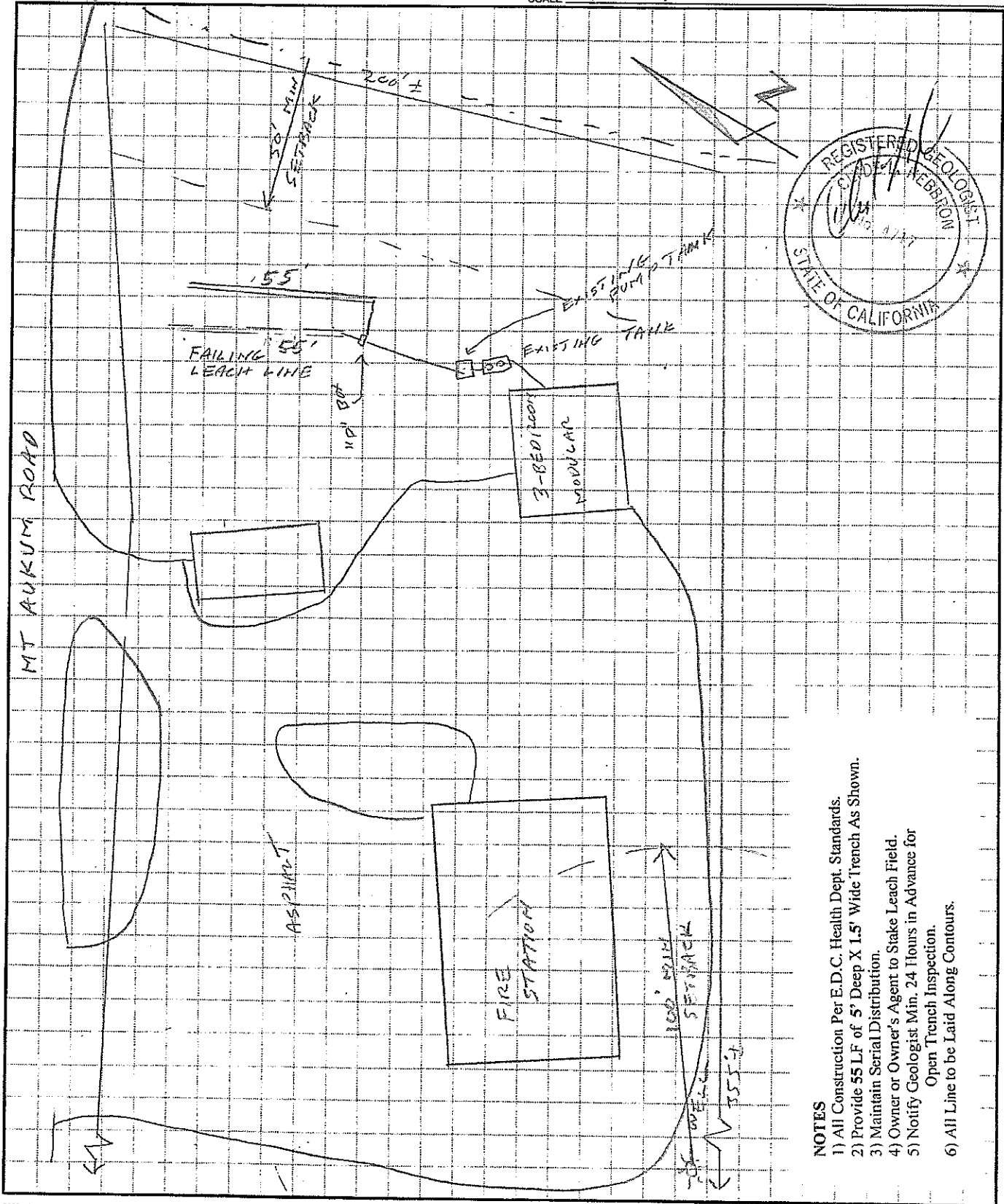

- NOTES**
- 1) All Construction Per E.D.C. Health Dept. Standards.
 - 2) Provide 55 LF of 5' Deep X 1.5' Wide Trench As Shown.
 - 3) Maintain Serial Distribution.
 - 4) Owner or Owner's Agent to Stake Leach Field.
 - 5) Notify Geologist Min. 24 Hours in Advance for Open Trench Inspection.
 - 6) All Line to be Laid Along Contours.